

6+1/8", WX-152D Rigid Line Components

Rigid Line

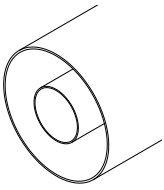

FEATURES

- Available in Aluminum-Copper and Copper-Copper (On Request)
- 2 or 4 m (6.6 or 13.1 ft) lengths
- Rigid Line cutter available on request

SPECIFICATIONS

Max RMS Power ⁽³⁾		Default	Painted ⁽²⁰⁾
	UHF	59.0 kW	74.0 kW (700 MHz)
	VHF B.III	104.0 kW	130.0 kW (230 MHz)
	VHF B.I	168.0 kW	210.0 kW (88 MHz)
	FM	151 kW	189.0 kW (108 MHz)
Outer Conductor	High Conductivity Aluminum Alloy High Conductivity Copper (On Request)		
Inner Conductor	High Conductivity Copper (ETP)		
Environmental Conditions	-5 to +55°C (+23 to +131°F), IP60		
Available lengths	2 or 4 m (6.6 or 13.1 ft)		
Code	D-RL152O	6+1/8" Rigid Line Outer (Al)	
	D-RL152CO	6+1/8" Rigid Line Outer (Cu)	
	D-RL152I	6+1/8" Rigid Line Inner	

⁽³⁾ Altitude < 1500 m (4,900 ft.), Free air, Ambient temp. < 30 °C (86 °F)

⁽²⁰⁾ Provided unpainted; to be painted by Customer after installation

Inner Connection



FEATURES

- Required to connect two Flange connections
- Includes screw-set for the relative Flange connections

SPECIFICATIONS

Max RMS Power ⁽³⁾	UHF	74.0 kW	(700 MHz)
	VHF B.III	130.0 kW	(230 MHz)
	VHF B.I	210.0 kW	(88 MHz)
	FM	189.0 kW	(108 MHz)
	Environmental Conditions	-5 to +55°C (+23 to +131°F), IP60	
Code	D-CF152V	6+1/8" <i>FastLine</i> Flange ⁽¹⁴⁾	
Options	O-NNB.05	6+1/8" Flange screw set	

⁽³⁾ Altitude < 1500 m (4,900 ft.), Free air, Ambient temp. < 30 °C (86 °F)

⁽¹⁴⁾ Inner Connections not included

Clamp Flange

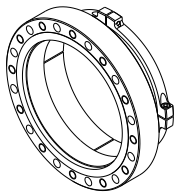

FEATURES

- Easy clamp-on to Rigid Lines outers and Socket connections
- Added threads for faster and simpler nut-free connection with other flanges

SPECIFICATIONS

Max RMS Power ⁽³⁾	UHF	74.0 kW	(700 MHz)
	VHF B.III	130.0 kW	(230 MHz)
	VHF B.I	210.0 kW	(88 MHz)
	FM	189.0 kW	(108 MHz)
	Return Loss (VSWR)	> 40 dB (1.02)	
Environmental Conditions	-5 to +55°C (+23 to +131°F), IP60		
Code	D-IC152V	6+1/8" Inner Connection	

⁽³⁾ Altitude < 1500 m (4,900 ft.), Free air, Ambient temp. < 30 °C (86 °F)

Plug Elbow

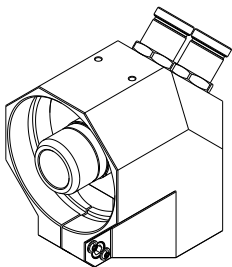

FEATURES

- 90° Elbow with Plugs on both sides
- Fine Match screw

SPECIFICATIONS

Max RMS Power ⁽³⁾	UHF	74.0 kW	(700 MHz)
	VHF B.III	130.0 kW	(230 MHz)
	VHF B.I	210.0 kW	(88 MHz)
	FM	189.0 kW	(108 MHz)
	Return Loss (VSWR)	> 40 dB (1.02)	
Environmental Conditions	-5 to +55°C (+23 to +131°F), IP60		
Code	D-EC152W	6+1/8" <i>FastLine</i> Plug Elbow	

⁽³⁾ Altitude < 1500 m (4,900 ft.), Free air, Ambient temp. < 30 °C (86 °F)

6+1/8", WX-152D Rigid Line Components

Modular Elbow

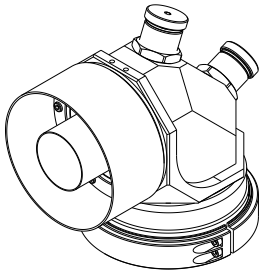

FEATURES

- 90° Elbow, allowing a wide choice of connections on both sides
- Zero and Recessed Cutback versions available
- Modular Connector System

SPECIFICATIONS

Max RMS Power ⁽³⁾	UHF	48.0 kW	(700 MHz)
	VHF B.III	83.0 kW	(230 MHz)
	VHF B.I	134.0 kW	(88 MHz)
	FM	121.0 kW	(108 MHz)
Return Loss (VSWR)	> 40 dB (1.02)		
Environmental Conditions	-5 to +55°C (+23 to +131°F), IP60		
Code	D-AC150	150 mm Modular Elbow	
Connections ⁽⁸⁾	D-PC150S	RL-120 <i>FastLine</i> Socket	
	D-PC150X	RL-120 <i>FastLine</i> Flange ⁽¹⁴⁾	
	D-PC150T	RL-120 <i>Fast Line</i> Plug	
	D-PC150U	6+1/8" <i>FastLine</i> Socket	
	D-PC150V	6+1/8" <i>FastLine</i> Flange ⁽¹⁴⁾	
	D-PC150W	6+1/8" <i>FastLine</i> Plug	
Options	O-NNB.02	1+5/8" Flange screw set	
	O-NNB.01	7/8" Flange screw set	
	O-NFM.01	Fine-match screw removal	

⁽³⁾ Altitude < 1500 m (4,900 ft.), Free air, Ambient temp. < 30 °C (86 °F)

⁽⁸⁾ Other Connections available ⁽¹⁴⁾ Inner Connections not included

Modular Junction

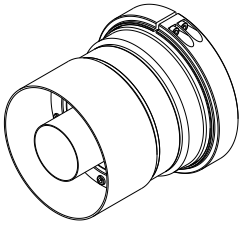

FEATURES

- Straight Junction, allowing a wide choice of connections on both sides.
- Zero and Recessed Cutback versions available
- Modular Connector System

SPECIFICATIONS

Max RMS Power ⁽³⁾	UHF	48.0 kW	(700 MHz)
	VHF B.III	83.0 kW	(230 MHz)
	VHF B.I	134.0 kW	(88 MHz)
	FM	121.0 kW	(108 MHz)
Return Loss (VSWR)	> 40 dB (1.02)		
Environmental Conditions	-5 to +55°C (+23 to +131°F), IP60		
Code	D-SC150	150 mm Modular Junction	
Connections ⁽⁸⁾	D-PC150S	RL-120 <i>FastLine</i> Socket	
	D-PC150X	RL-120 <i>FastLine</i> Flange ⁽¹⁴⁾	
	D-PC150T	RL-120 <i>Fast Line</i> Plug	
	D-PC150U	6+1/8" <i>FastLine</i> Socket	
	D-PC150V	6+1/8" <i>FastLine</i> Flange ⁽¹⁴⁾	
	D-PC150W	6+1/8" <i>FastLine</i> Plug	
Options	O-NNB.02	1+5/8" Flange screw set	
	O-NNB.01	7/8" Flange screw set	

⁽³⁾ Altitude < 1500 m (4,900 ft.), Free air, Ambient temp. < 30 °C (86 °F)

⁽⁸⁾ Other Connections available ⁽¹⁴⁾ Inner Connections not included